

MANOR

8 FYFIELD CLOSE
WANTAGE | OX12 8HN



A well-presented three-bedroom semi-detached family home offering comfortable living accommodation in a popular residential area of Wantage.

The property provides versatile living space ideal for families or professionals, comprising three good-sized bedrooms, family bathroom, spacious living/dining room, and a well-appointed kitchen. The integral garage offers excellent storage or potential for conversion, subject to necessary consents.

The rear garden has been landscaped and features a generous paved patio area with French door access from the living room, . Mature planted borders and lawn. Off-street parking available.

Fyfield Close is situated in a sought-after residential area of Wantage, providing easy access to local schools, amenities, and transport links. The town centre, with its range of shops, restaurants, and services, is within easy reach, while the A338 provides excellent connectivity to Oxford, Newbury, and the M4 corridor.

3



|



|











- Parking
- Garage
- Good Location
- Transport Links
- Schools Nearby
- Amenities Nearby

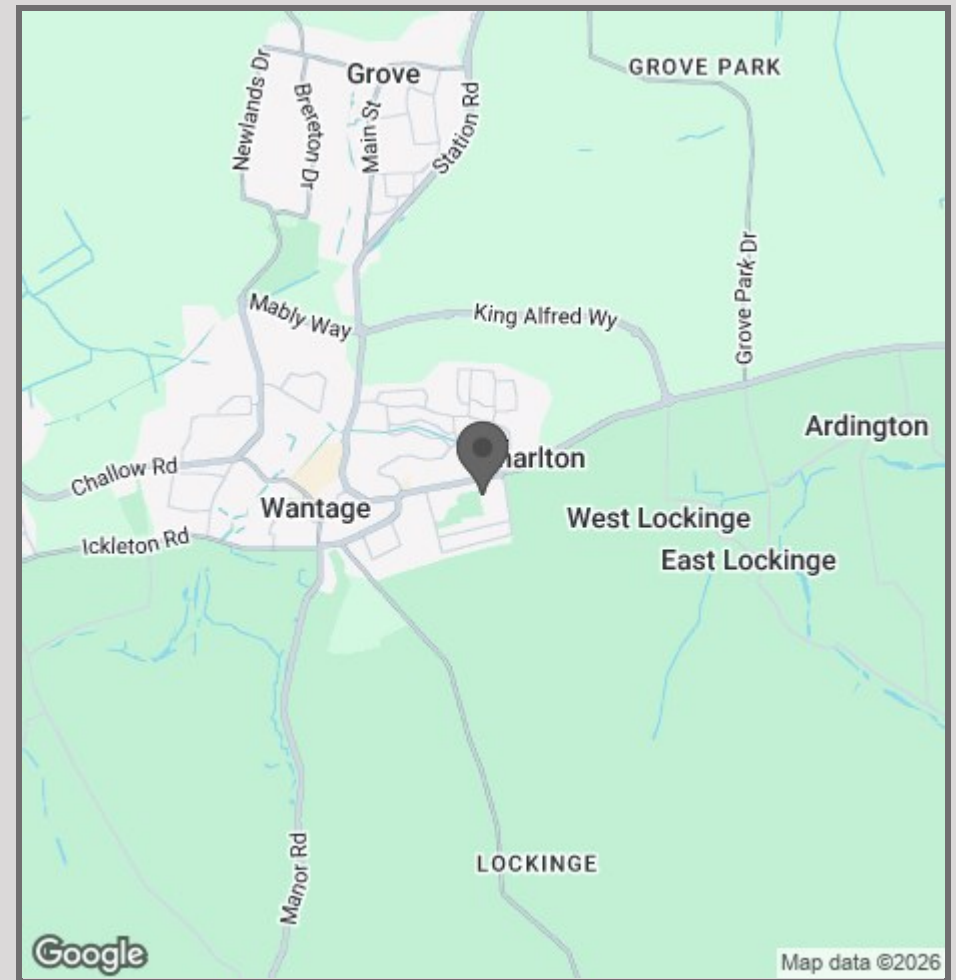

42 High Street
Woodstock
OX20 1TG

01865 955500

hello@manoroxford.com

www.manoroxford.com

MANOR



GROUND FLOOR

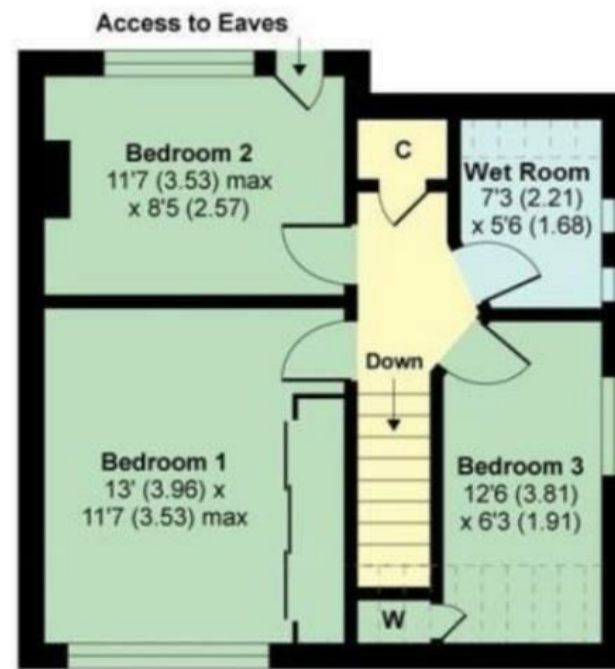

FIRST FLOOR



MANOR